



# MxDisplay+

This quick start guide introduces the most important functions and helps you to set up and configure the MxDisplay+.



32.401-001\_EN\_07/2015

## First Steps

After the MxDisplay+ has been connected, it starts and shows the date and time (stand-by mode). Tap on the screen and select the Installation Wizard. The wizard leads you through several steps to add and configure door stations and cameras. It assists you in selecting the language, installing the network, searching for devices and changing the user name and password. The wizard also assists you in assigning door bells and setting the time server. The MxDisplay+ automatically switches off after one minute in order to conserve energy. You can change this behavior in **Settings > MxDisplay Settings > Screensaver**.



## At a Glance

In stand-by mode, you see at one glance:

1. the time and date of the selected time server
2. the temperature of the selected sensor (only available if an MX-GPS-Box has been attached)
3. how many visitors rang the door bell, when this happened and how many events occurred (tapping on the corresponding icon shows the event image to the last event)
4. the WiFi status
5. if the bell is muted (the display periodically switches between this icon and stand-by mode)



## The Main Menu

From stand-by mode, you can enter the main menu either by tapping on the screen ( 1 ) or by tapping on the **Home** button ( 2 ). In the main menu, you activate the “Do not disturb” function ( 3 ) for all connected devices and the “Mute bell” function ( 4 ) only for this device. In addition, you see the reference image ( 5 ) of the first camera in the camera list and you can select cameras from the camera list ( 6 ) by pulling down the camera bar at the top and tapping on the desired camera. You see the different camera status ( 7 ), will be informed about events ( 8 ) and can open the system settings ( 9 ). The system settings include the basic settings as well as all settings for day-to-day operation of the MxDisplay+, from bell behavior to camera configuration and access control.



## The Live View

In the live view, you can see the live image of each camera integrated in the system and control the cameras using sliders. Sliders are used to change the speaker volume, the image brightness, to select preconfigured image sections, adjust the volume of the ringing tone, start a snapshot recording, talk to visitors at the door, open the door and switch lights. To show the sliders, tap on the live image. To see another camera image, either pull down the camera strip ( 1 ) and tap on the desired camera image or tap on the camera image in the main menu.

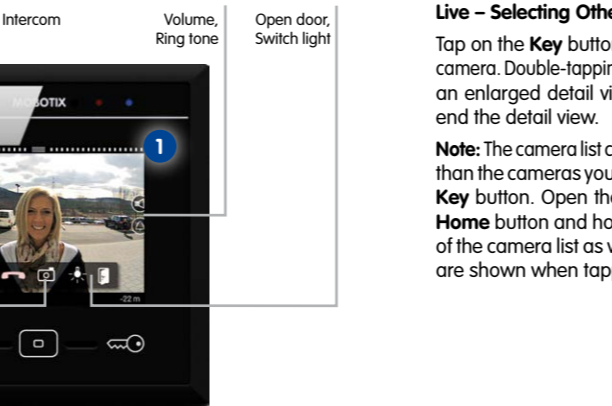

## Live – Door Bell is Ringing

When the door bell rings, MxDisplay+ shows the live image of the door camera with the corresponding controls.

## Live – Intercom, Opening Doors and Switching Lights

To speak to a visitor at the door, tap on the green receiver button ( 1 ). To close the audio connection, tap on the red receiver. If you want to open the door, tap on the **Door** button ( 2 ) and to switch light, tap on the **Light** button ( 3 ), if this camera can switch lights.

## Live – Selecting Other Cameras and the Detailed View

Tap on the **Key** button ( 4 ) to show a different camera. Double-tapping into the live image shows an enlarged detail view. Double-tap again to end the detail view.

**Note:** The camera list can show different cameras than the cameras you see when tapping on the **Key** button. Open the camera list, tap on the **Home** button and hold it to define the content of the camera list as well as the “favorites” that are shown when tapping on the **Key** button.

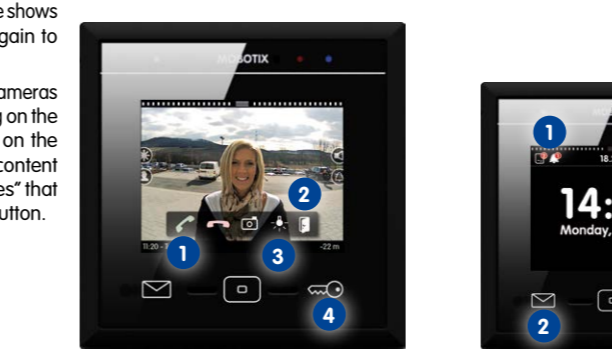

## The Event List

MxDisplay+ shows the number of new events in the top left corner of the screen ( 1 ). The **Event** list shows all recorded events with a preview image, the date and time of the event, the event type that triggered the recording and the camera name. To open this list, tap on the **Envelope** button ( 2 ). All mailbox messages are listed in one list and all other events are listed in another list. Tap again on the **Envelope** button ( 2 ) to switch between lists. If you want to show only specific cameras or time ranges, simply tap on the magnifying glass, select the camera(s) and the time range, then tap on **Search** ( 3 ). Use the **List/Single image** switch to change the event list display accordingly.

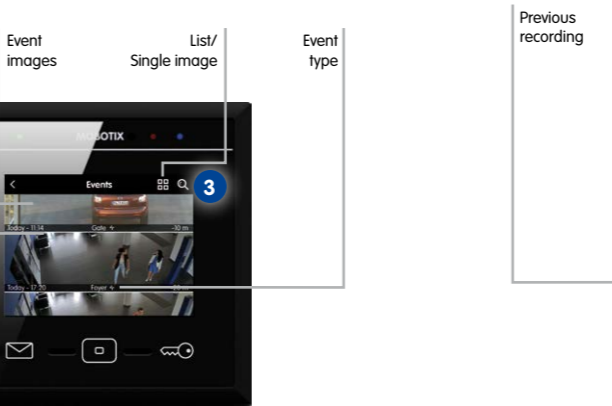

## The Player

To play back a recording, tap on an event image in the event list. The player to this event list opens. You can now play back the recordings of the events in this list. Or you can open the camera strip, then tap and hold on one of the live images. Several icons are shown. Tap on **Playback** to open the player. In the player, tap on **Playback** ( 1 ) again to play back the recording. Tap on the **Fast Forward/Rewind** buttons to move within one recording ( 2 ) and tap on the **Next** and **Previous** buttons to move between recordings ( 3 ).

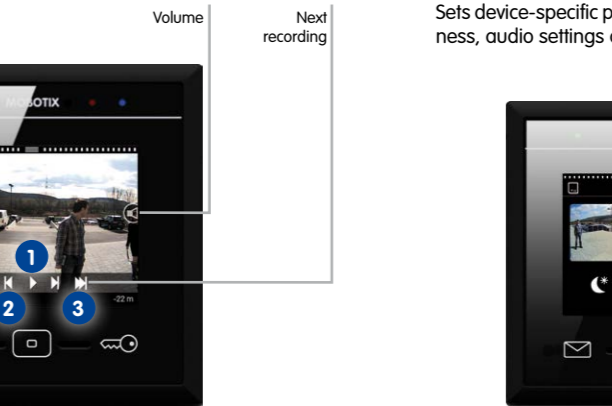

## System Settings All at One Location

Regardless of whether you want to change the bell behavior, adjust device-specific settings, configure the cameras or the system, everything is clearly located in one menu. To open this menu, tap on **Settings** ( 1 ) in the main menu.

## Bell Behavior

Configures the desired bell behavior for each bell. The bell behavior includes, for example, the ringing tone or the selection of the mailbox announcement.

## MxDisplay+ Settings

Sets device-specific parameters for this MxDisplay+: screen saver, language and brightness, audio settings and illumination of the buttons.



## Installation

This menu item contains the **Camera List** to add and delete cameras, the **Camera Configuration** with the options to lock the auto configuration for door cameras, to set up recordings and to configure the bell buttons of the door station modules. In addition, the **Display Configuration** allows to assign door bells, to configure the network, to set up a time server and to manage settings. The **Installation Wizard** opens with the first start of the MxDisplay+, however, you can open it any time later in this menu.

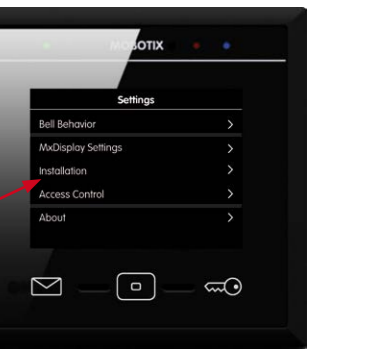

## Camera List

Use this list to add cameras and door stations and to edit them later on. Tap on **Settings > Installation > Camera List** to open the list.

### • Adding cameras using Bonjour

Tap on Plus (+) and start the camera search (magnifying glass) to list the cameras that are found. Select a camera, enter a name, then enter the user name and password. Confirm by tapping on the checkmark in the top right corner.

### • Adding cameras manually

Tap on Plus (+) and then on **Manually Adding**. Enter the camera name and the URL (incl. port), the user name and password.

### • Editing the camera list

Tap on **Edit** to delete cameras, to change the sorting order and to select cameras as “favorites” (tap on the **Key** button).

## Camera Configuration

Tap on **Settings > Installation > Camera Configuration** to change various settings on the camera. Select the camera you want to modify. For door stations, you can lock the auto configuration to avoid accidental reconfiguration. To configure recording, tap on **Recording** and adjust the parameters as needed. Then select the events that are supposed to trigger a recording. To configure the door bell(s), activate the bell button, configure the BellRFID bell buttons and the contact numbers. You can also change the camera password of the “Admin” user in this menu.

## MxDisplay+ Configuration

Tap on **Settings > Installation > Display Configuration** to configure the MxDisplay+. You can assign the door bells to the MxDisplay+, set the LAN network parameters and activate the WiFi module of the MxDisplay+. In addition, you can select a time server and activate it. You can lock functions, manage settings and change the Administrator PIN (“0202” by factory default).

### Installation Wizard

The Installation Wizard helps you to add and configure door stations and cameras. The wizard opens when starting the MxDisplay+ for the first time, but it can also be opened later to add door stations and cameras. To open the wizard, tap on **Settings > Installation > Installation Wizard** and complete the individual steps.

## Access Control

Tap on **Settings > Access Control** to create new users and assign RFID cards/access PINs to users. You can create new tenants, add RFID cards and activate/deactivate RFID cards. You can also set access times for specific RFID cards. You assign additional PIN numbers, lock cards and assign rights to the cards (e.g., which doors can this card open, which mailboxes can it check and which MxDisplay+ functions can be protected by the card).

To add a new card, hold the card over the **Home** button and follow the instructions. This allows transferring the RFID cards of an integrated door station into the system (“card on camera” icon in the center) and to add further user cards after that. To initialize the RFID system without an integrated door station, you need to identify yourself using the Administrator PIN.

If the icon (1) is flashing red, the changes have not yet been saved on the cameras. Tap on the icon to permanently save the changes.

## Personalized Interface Settings Fast and Easy

In order to quickly access often-used functions, you can create customized views. One view can be used to group up to nine functions with the corresponding icons and customized colors. To move from the main menu to the view(s), simply swipe over the screen with one finger.

Open the main menu (tap on the screen in stand-by mode). Then tap and hold the **Home** button (1). Tap on Plus (+) in the top right corner to create a new view. Then tap on Plus (+) in the center of the screen to add function buttons and to set their appearance for this view.

## Initial Operation

Make sure that the camera is using a camera firmware version 4.2.3 or higher. For further information, see the *Compact Guide: Firmware Update* ([www.mobotix.com](http://www.mobotix.com) > **Support > Manuals > Software > Compact Guides**). To update the MxDisplay+ software, start a browser, enter the IP address of the MxDisplay+ (user **admin**, password **meinSM**) and then select **Update System Software**.

**Note:** By factory default, the MxDisplay+ has been set to run as DHCP client. In addition, it has a local 10.x IP address (see sticker on the back) with a network mask of 255.0.0.0.

### Starting up Door Stations and Setting Up MxDisplay+ as Remote Station

The complete startup using only MxDisplay+ will be possible with a later software version. Until this is the case, follow the same steps outlined in *Chapters 2 to 4 of the T25 System Manual Part 2* ([www.mobotix.com](http://www.mobotix.com) > **Support > Manuals > IP Video Door Station**).

### 1. Power:

All devices have to be connected to the network and supplied with power.

### 2. Auto configuration:

Carry out the auto configuration at the door station (see Section 2.1.3 in the *T25 System Manual Part 2*). When using several door stations, choose one as a master and then carry out the auto configuration on that door station. The auto configuration is completed by entering the Super PIN at the access modules (KeypadRFID or BellRFID).

### 3. Access modules:

Set up the access modules that are used, including training the RFID cards, entering the contact/people/PIN numbers (if applicable) and configuring the bell buttons on the BellRFID modules (see the corresponding sections in the *T25 System Manual Part 2*).

### 4. MxDisplay+:

Reboot the MxDisplay+ by simultaneously holding the **Envelope**, **Home** and **Key** buttons until a beep sounds five times in a row. Start the **Installation Wizard**

## Access Control

Tap on **Settings > Access Control** to create new users and assign RFID cards/access PINs to users. You can create new tenants, add RFID cards and activate/deactivate RFID cards. You can also set access times for specific RFID cards. You assign additional PIN numbers, lock cards and assign rights to the cards (e.g., which doors can this card open, which mailboxes can it check and which MxDisplay+ functions can be protected by the card).

To add a new card, hold the card over the **Home** button and follow the instructions. This allows transferring the RFID cards of an integrated door station into the system (“card on camera” icon in the center) and to add further user cards after that. To initialize the RFID system without an integrated door station, you need to identify yourself using the Administrator PIN.

### Starting up Door Stations and Setting Up MxDisplay+ as Remote Station

The complete startup using only MxDisplay+ will be possible with a later software version. Until this is the case, follow the same steps outlined in *Chapters 2 to 4 of the T25 System Manual Part 2* ([www.mobotix.com](http://www.mobotix.com) > **Support > Manuals > IP Video Door Station**).

### 1. Power:

All devices have to be connected to the network and supplied with power.

### 2. Auto configuration:

Carry out the auto configuration at the door station (see Section 2.1.3 in the *T25 System Manual Part 2*). When using several door stations, choose one as a master and then carry out the auto configuration on that door station. The auto configuration is completed by entering the Super PIN at the access modules (KeypadRFID or BellRFID).

### 3. Access modules:

Set up the access modules that are used, including training the RFID cards, entering the contact/people/PIN numbers (if applicable) and configuring the bell buttons on the BellRFID modules (see the corresponding sections in the *T25 System Manual Part 2*).

### 4. MxDisplay+:

Reboot the MxDisplay+ by simultaneously holding the **Envelope**, **Home** and **Key** buttons until a beep sounds five times in a row. Start the **Installation Wizard**

## Personalized Interface Settings Fast and Easy

In order to quickly access often-used functions, you can create customized views. One view can be used to group up to nine functions with the corresponding icons and customized colors. To move from the main menu to the view(s), simply swipe over the screen with one finger.

Open the main menu (tap on the screen in stand-by mode). Then tap and hold the **Home** button (1). Tap on Plus (+) in the top right corner to create a new view. Then tap on Plus (+) in the center of the screen to add function buttons and to set their appearance for this view.

## Initial Operation

Make sure that the camera is using a camera firmware version 4.2.3 or higher. For further information, see the *Compact Guide: Firmware Update* ([www.mobotix.com](http://www.mobotix.com) > **Support > Manuals > Software > Compact Guides**). To update the MxDisplay+ software, start a browser, enter the IP address of the MxDisplay+ (user **admin**, password **meinSM**) and then select **Update System Software**.

**Note:** By factory default, the MxDisplay+ has been set to run as DHCP client. In addition, it has a local 10.x IP address (see sticker on the back) with a network mask of 255.0.0.0.

### Starting up Door Stations and Setting Up MxDisplay+ as Remote Station

The complete startup using only MxDisplay+ will be possible with a later software version. Until this is the case, follow the same steps outlined in *Chapters 2 to 4 of the T25 System Manual Part 2* ([www.mobotix.com](http://www.mobotix.com) > **Support > Manuals > IP Video Door Station**).

### 1. Power:

All devices have to be connected to the network and supplied with power.

### 2. Auto configuration:

Carry out the auto configuration at the door station (see Section 2.1.3 in the *T25 System Manual Part 2*). When using several door stations, choose one as a master and then carry out the auto configuration on that door station. The auto configuration is completed by entering the Super PIN at the access modules (KeypadRFID or BellRFID).

### 3. Access modules:

Set up the access modules that are used, including training the RFID cards, entering the contact/people/PIN numbers (if applicable) and configuring the bell buttons on the BellRFID modules (see the corresponding sections in the *T25 System Manual Part 2*).

### 4. MxDisplay+:

Reboot the MxDisplay+ by simultaneously holding the **Envelope**, **Home** and **Key** buttons until a beep sounds five times in a row. Start the **Installation Wizard**

## Integrating MxDisplay+ into an Existing Door System

1. **MxDisplay+:** Integrate the MxDisplay+ into the network with the MOBOTIX door stations and cameras as described in the supplied *MxDisplay+ Quick Install*. Establish the power supply (PoE or power adapter).

2. **Installation Wizard:** After the MxDisplay+ has been connected, it shows the date and time (stand-by mode). Open the Installation Wizard (tap on the screen). Follow the individual steps and assign the desired bells to the MxDisplay+. This can be changed later on in **Settings > Installation > Display Configuration > Assign Door Bells**.

## Integrating MxDisplay+ into an Existing Door System

1. **MxDisplay+:** Integrate the MxDisplay+ into the network with the MOBOTIX door stations and cameras as described in the supplied *MxDisplay+ Quick Install*. Establish the power supply (PoE or power adapter).

2. **Installation Wizard:** After the MxDisplay+ has been connected, it shows the date and time (stand-by mode). Open the Installation Wizard (tap on the screen). Follow the individual steps and assign the desired bells to the MxDisplay+. This can be changed later on in **Settings > Installation > Display Configuration > Assign Door Bells**.

## Integrating MxDisplay+ into an Existing Door System

1. **MxDisplay+:** Integrate the MxDisplay+ into the network with the MOBOTIX door stations and cameras as described in the supplied *MxDisplay+ Quick Install*. Establish the power supply (PoE or power adapter).

2. **Installation Wizard:** After the MxDisplay+ has been connected, it shows the date and time (stand-by mode). Open the Installation Wizard (tap on the screen). Follow the individual steps and assign the desired bells to the MxDisplay+. This can be changed later on in **Settings > Installation > Display Configuration > Assign Door Bells**.

## Integrating MxDisplay+ into an Existing Door System

1. **MxDisplay+:** Integrate the MxDisplay+ into the network with the MOBOTIX door stations and cameras as described in the supplied *MxDisplay+ Quick Install*. Establish the power supply (PoE or power adapter).

2. **Installation Wizard:** After the MxDisplay+ has been connected, it shows the date and time (stand-by mode). Open the Installation Wizard (tap on the screen). Follow the individual steps and assign the desired bells to the MxDisplay+. This can be changed later on in **Settings > Installation > Display Configuration > Assign Door Bells**.

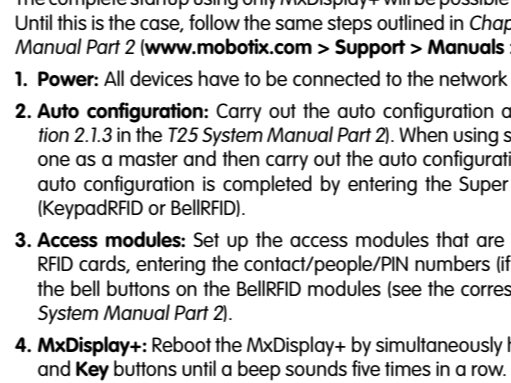
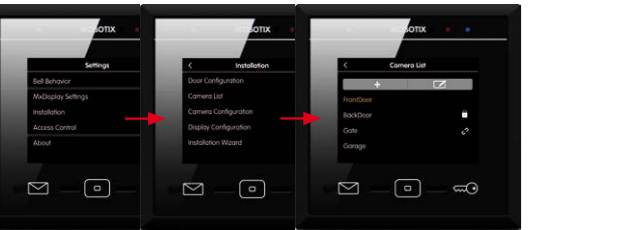

## Further Information

Instructions and informations about installing and setting up the MxDisplay+ units can be found in the *MxDisplay+ Quick Install* ([www.mobotix.com](http://www.mobotix.com) > **Support > Manuals**).

## Support

Open [www.mobotix.com](http://www.mobotix.com) > **Support > Support** to contact our technical support.

## MOBOTIX AG

D-67722 Langmeil  
Germany  
[www.mobotix.com](http://www.mobotix.com)